

Courses & Distances up
 the River from the Locust, Vizt.

S 87 W 32
 S 63 W 124
 S 41 W 70
 S 77 W 30
 N 73 W 30 to the W of
 in all 286 ps.

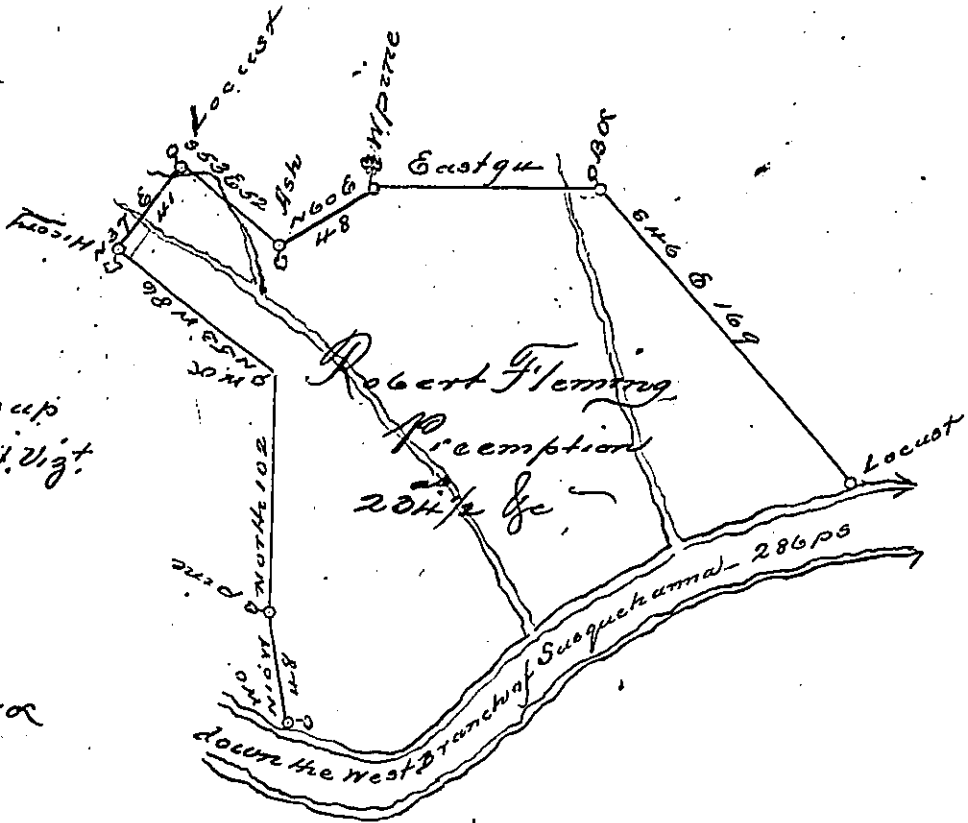

I surveyed the above described Tract of Land on the 10th day of the 6th mo. 1794. for Robert Fleming, in pursuance of a warrant ^{of preemption} dated the 2nd day of August 1785. Situate on the North side of the West Branch of Susquehanna River & about two & an half Miles below the mouth of Sinnamahoning — formerly known by the name of Meginley's Bottom, containing Two hundred & thirty four & an half acres & the allowance of six P Cent

William Ellis D.S.

Daniel Brodhead Esq.
 Surveyor General

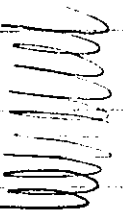

IN TESTIMONY that the above is a copy of the original remaining on file in the Department of Internal Affairs of Pennsylvania, made conformably to an Act of Assembly approved the 16th day of February, 1833, I have hereunto set my Hand and caused the Seal of said Department to be affixed at Harrisburg, this eleventh day of October 1904

Isaac D. Brown
 Secretary of Internal Affairs